

BOARD OF SUPERVISORS

MADISON COUNTY, MISSISSIPPI

Department of Engineering
Tim Bryan, P.E., PTOE, County Engineer

3137 South Liberty Street, Canton, MS 39046
Office (601) 855-5582 FAX (601) 859-5857

MEMORANDUM

February 27, 2024

To: Casey Brannon, Supervisor, District I
Trey Baxter, Supervisor, District II
Gerald Steen, Supervisor, District III
Karl Banks, Supervisor, District IV
Paul Griffin, Supervisor, District V

From: Tim Bryan, P.E., PTOE
County Engineer

Re: MDOT Right of Way Permit
Hwy 22 at Livingston Vernon and Cedar Hill Roads

The Engineering Department requests permission for the Board President to sign the attached Right-of-Way Permit Application to be submitted to MDOT requesting permission to construct the intersection improvements to the intersections of Hwy 22 at Livingston Vernon and Hwy 22 and Cedar Hill Roads.

CASEY BRANNON
District One

TREY BAXTER
District Two

GERALD STEEN
District Three

KARL M. BANKS
District Four

PAUL GRIFFIN
District Five

PERMIT NO. _____

Applicant Contact Name: _____

Applicant Contact Phone #: _____

**MISSISSIPPI DEPARTMENT OF TRANSPORTATION
APPLICATION FOR PERMIT TO LOCATE CERTAIN FACILITIES
ON OR TO PERFORM CERTAIN WORK ON STATE
HIGHWAY RIGHT OF WAY**

(Please Print) Name: _____ Address: _____
Company (or) Individual Street/Route

City County State Zip Code

herein called the applicant, who does hereby make application to the Mississippi Department of Transportation, the duly authorized agent for the Mississippi Transportation Commission, for permission to _____

_____ on or across

Highway No. _____ between _____ and _____

Latitude (decimal degrees) _____ Longitude (decimal degrees) _____

in _____ County, Mississippi and in consideration of this permit being granted, said applicant does hereby agree to perform the above work in accordance with the plan shown herein below and does further agree, with full understanding of the terms thereof, to the following provisions:

- (a) That the Mississippi Department of Transportation does not purport to grant to said applicant any right, title, claim or easement in or upon said highway or right-of-way appurtenant thereto.
- (b) The plan of the proposed work or facility set out below or attached hereto is incorporated herein by reference and made a part of this application as if fully described herein by words and figures.
- (c) It is agreed that this permit is void if all work shown on this plan is not completed in accordance with this plan within one year after date of approval.
- (d) It is agreed that no trees or shrubs on the highway right-of-way will be cut, trimmed, or damaged during the process of the proposed work or maintenance of this work or facility except as shown on the plan.
- (e) All sod disturbed by the proposed work shall be neatly dressed and grassed in accordance with the vegetation schedule outlined elsewhere in this permit. The applicant shall maintain the dressed and grassed area for a sufficient length of time to insure a growing sod.
- (f) The applicant is responsible for any conflicts with other utilities on the highway right-of-way and is to secure permission from said utilities for any necessary alterations.
- (g) The Mississippi Department of Transportation may at any time require and compel the removal or relocation of any facility herein described, shown or referred to, when said Mississippi Department of Transportation deems it necessary. All expense of said removal or relocation is to be borne exclusively by the applicant, and the Mississippi Department of Transportation is to be in no way liable.
- (h) The applicant accepts the responsibility of the safety of the traveling public and his/her workers and agrees to furnish, place and maintain traffic control devices, if required, in accordance with Part 6 of the Manual On Uniform Traffic Control Devices For Streets and Highways (MUTCD), Current Edition as a minimum. The applicant shall attach a special traffic control plan to the application if special traffic control details are required.
- (i) All work associated with this permit shall be designed, detailed and constructed in accordance with the Department's Roadway and Bridge Design Manuals and Standard Drawings and the Mississippi Standard Specifications for Road and Bridge Construction.
- (j) The Mississippi Department of Transportation in granting this permit does not in any way assume the maintenance or upkeep of the facility or proposed improvement herein described. Nor, will the Mississippi Department of Transportation be held responsible for any damage, which may be inadvertently done to this facility or proposed improvement regardless of the source or cause of such damage.
- (k) A copy of the approved plan is to be kept at the site of the work at all times while work is in progress.
- (l.) Said applicant hereby expressly agrees for himself, his heirs, assigns and legal representatives, that upon request of said Mississippi Department of Transportation, he will without delay either reconstruct, remove or move the facility herein described to another location, all in accordance with the terms of the request so made by the said Mississippi Department of Transportation. It is distinctly understood that said new location will be made or designated by said Mississippi Department of Transportation after agreement with said applicant or its successors, if possible. It is further understood and agreed that, if this permit is granted and acted upon by the said applicant, the said Mississippi Department of Transportation will use all reasonable effort to avoid the necessity of requesting that the herein mentioned facility be removed, moved, altered, or reconstructed.

(m.) The applicant does hereby covenant and agree to indemnify and hold harmless the Mississippi Transportation Commission and the Mississippi Department of Transportation from and against any claims, actions, suits, causes or demands, including court costs and reasonable attorney's fees, proximately resulting from acts or omissions of the applicant, or applicant's servants, agents or employees in the construction and maintenance of all facilities outlined under this permit.

Witness my signature this _____ day of _____, 20____, which is applicable to sheets 1
through _____ of permit number _____.

Signature of Applicant

By: _____
Printed Name and Title

STATE OF MISSISSIPPI
COUNTY OF _____

Personally appeared before me, the undersigned authority, _____ whose
Printed Name of Applicant

names(s) _____ subscribed to this instrument as the _____ of
is/are Title of Applicant

_____ who having been first fully sworn acknowledged that they
Name of Company (or) Individual

executed the above agreement as the act and deed of the said applicant for the purpose and consideration and in the capacity therein expressed and on the date above written.

Given under my hand and seal of office this the _____ day of _____, 20____

My Commission Expires:

Signature of Notary Officer

Field Inspection By: _____ 20____

Approved: MISSISSIPPI DEPARTMENT OF TRANSPORTATION

Deputy Executive Director/Chief Engineer

By: _____ 20____

Installation Inspection By: _____ 20____

Mississippi Department of Transportation
Completion of Work Certification

This permit requires that the named applicant submit the following certification with signature(s) and insure proper filing with MDOT's District Permit Department before the permit is closed and all associated bonds are released:

Permit Representative's signature(s) acknowledges the following:

We/(I), certify that the requirements of this permit have been constructed as stated in the approved final permit. Furthermore, no work performed as an exercise of the approved permit, has been relocated or altered without such change being shown on an approved revision of the permit or approved addenda thereto.

Printed Name of Applicant

Signature of Applicant

Permit No.: _____

REVISIONS			
APPLICANT		MDOT	
DATE	BY	DATE	BY

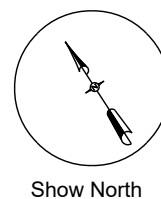

SCALE: 1"=40'

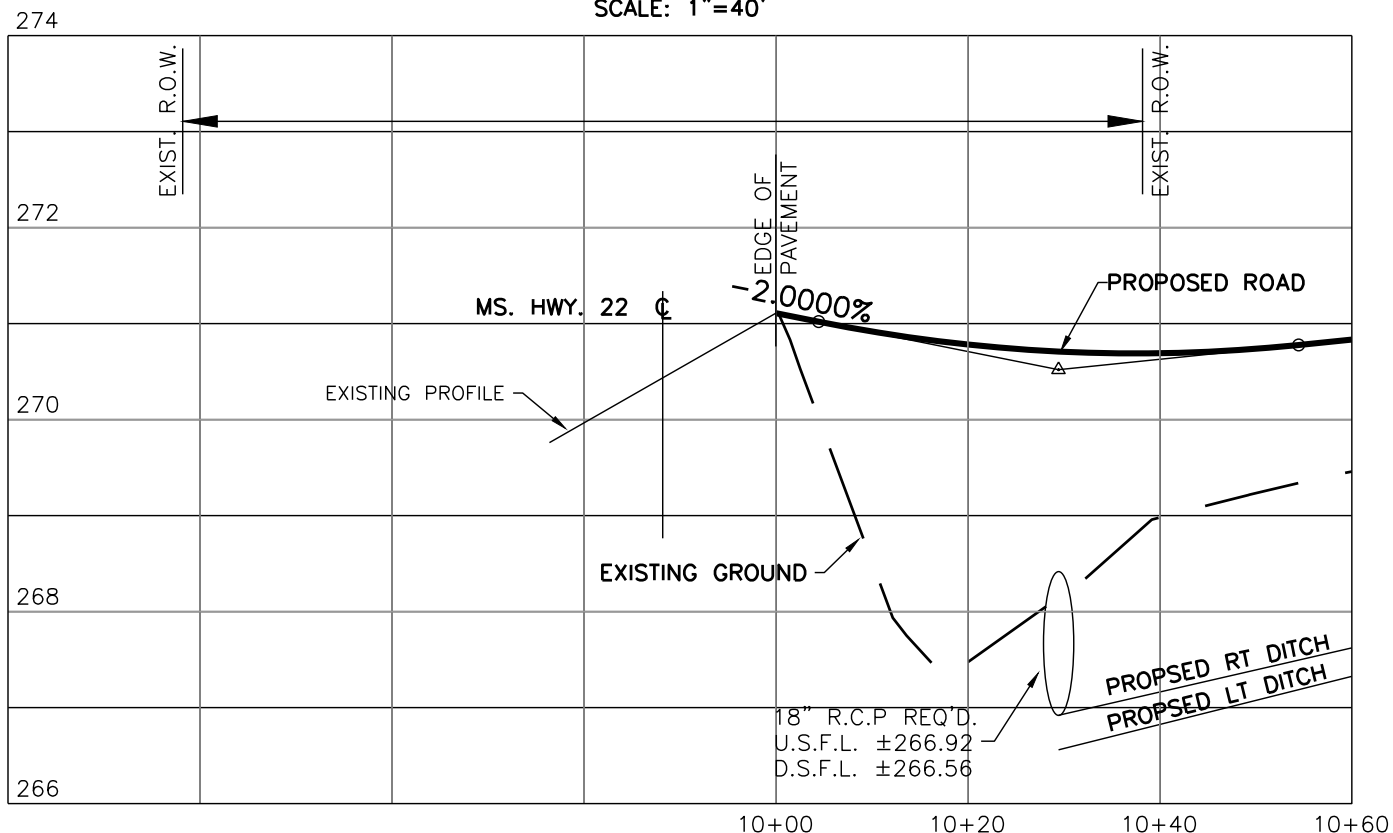

SCALE: 1"=20' HOR.
1"=2' VERT.

Sheet No.: _____ of _____

Permit No.: _____

LAT. 32.556786°
LONG. -90.243365°

REVISIONS			
APPLICANT		MDOT	
DATE	BY	DATE	BY

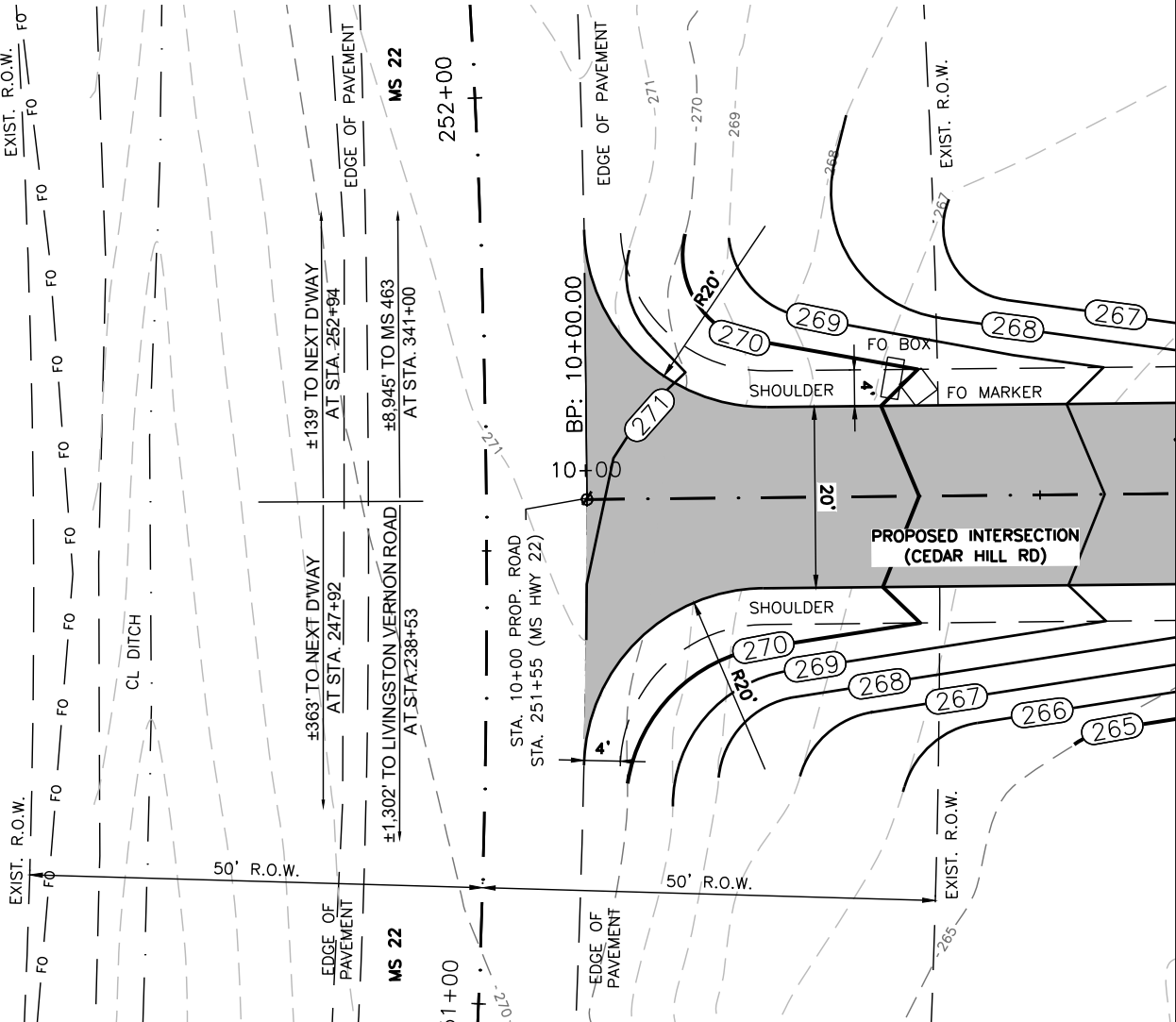

PLAN VIEW
SCALE: 1"=20'

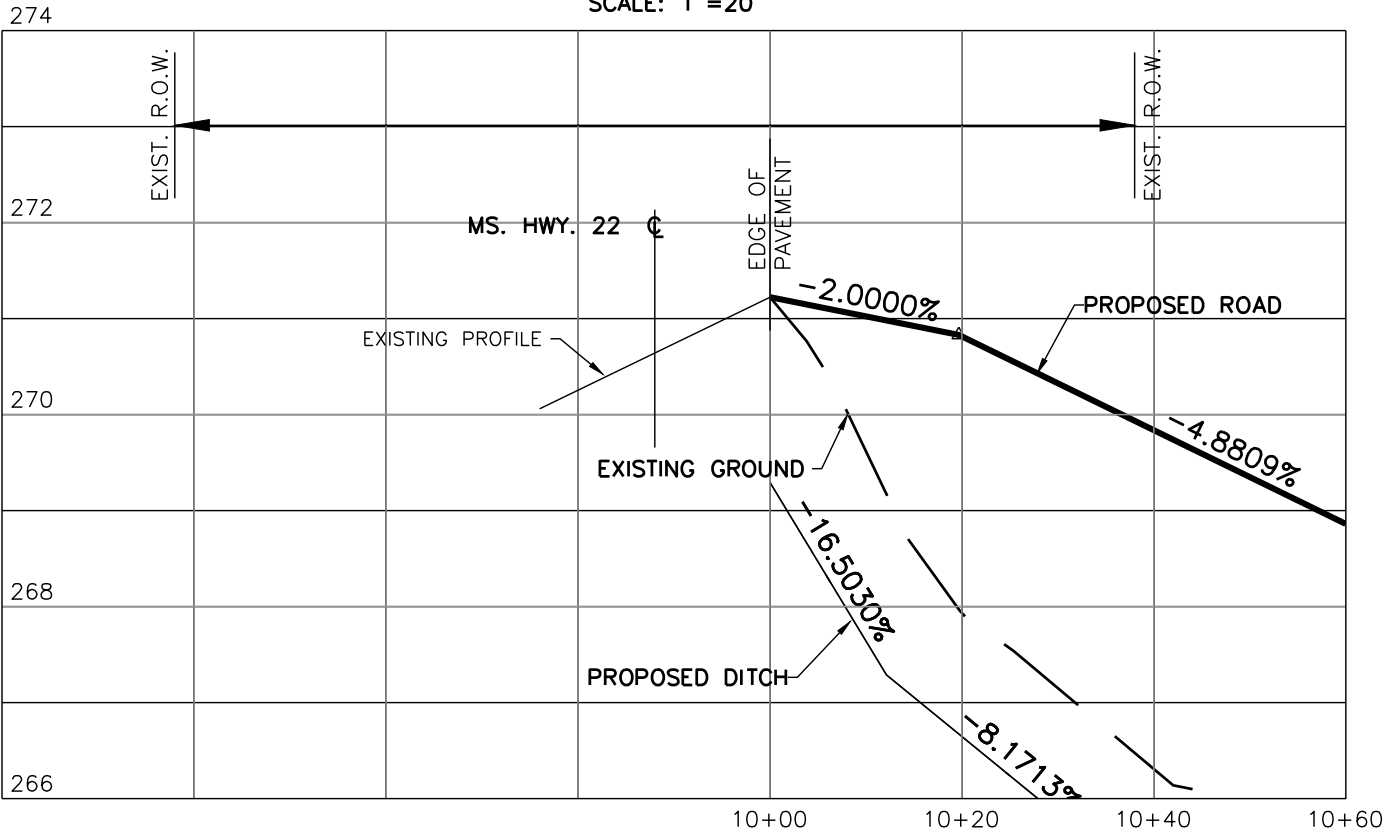

PROFILE
SCALE: 1"=20' HOR.
1"=2' VERT.

Sheet No.: _____ of _____

Permit No.: _____

LAT. 32.556786°
LONG. -90.243365°

REVISIONS			
APPLICANT		MDOT	
DATE	BY	DATE	BY

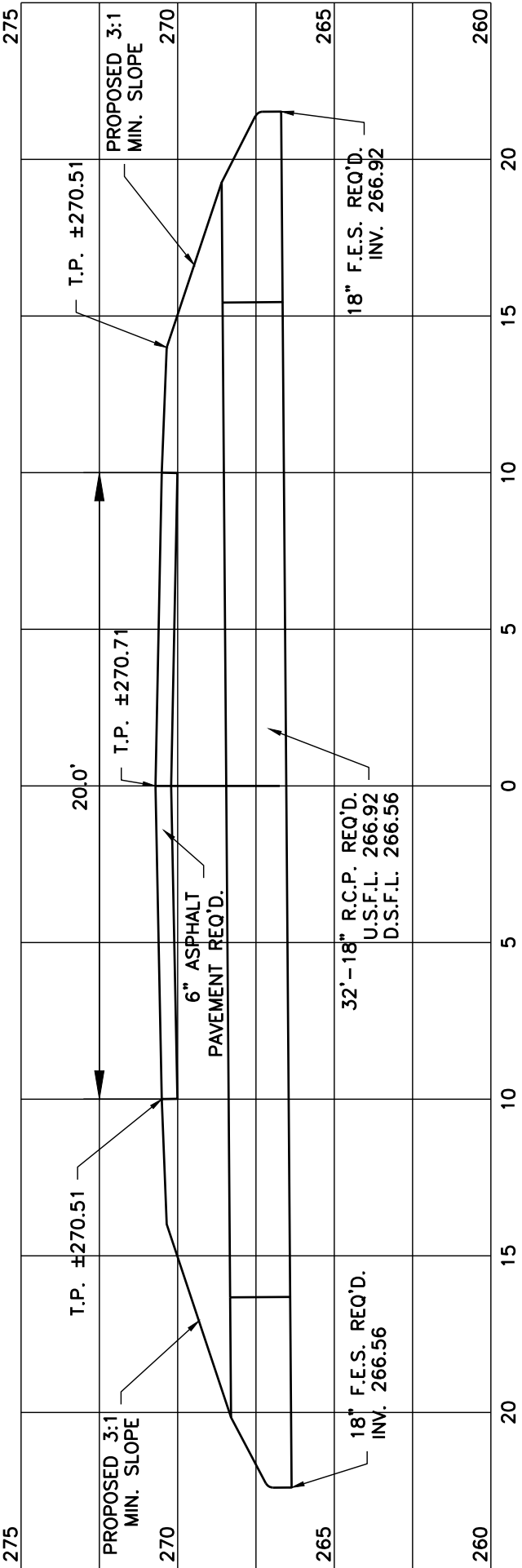
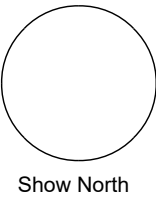

CROSS-SECTION OF DRIVEWAY AT HIGHWAY 22 STA. 238+53

SCALE: 1"=5'

SHEET NO. _____ OF _____
PERMIT NO. _____

REVISIONS			
APPLICANT		MDOT	
DATE	BY	DATE	BY

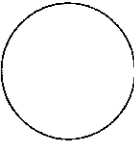

SHOW NORTH

Erosion control implementation schedule:

Phase 1: BMP's are to be installed before any major land disturbing activity. Silt fence is to be installed as depicted in the Erosion Control Plan Sheet and along the perimeter of the downstream side of any disturbed areas.

Phase 2: Soil stabilization - vegetative stabilization measures must be initiated whenever any clearing, grading, excavating, or other land disturbing activities have temporarily or permanently ceased on any portion of the site and will not resume for a period of fourteen (14) days or more. The appropriate temporary or permanent vegetative practices shall be implemented within seven (7) calendar days.
See Temporary Vegetation Schedule

Phase 3: Upon completion of work, any remaining permanent erosion control measures will be installed and any required permanent grassing will be finished.
See Permanent Grassing Schedule

Refer to attached MDOT standard drawings for details on installation

VEGETATION SCHEDULE

1600 All soil preparation, fertilizing, sprigging, seeding and work applied to same shall be in accordance with the following procedure and schedule.

1. SHAPE AREA. Shape all areas to typical cross section and dress same as required by the permit.
2. SPREAD FERTILIZER AND PREPARE SEED BED. The required fertilizer and agricultural limestone shall be spread uniformly over the area to be top seeded. after the fertilizer and limestone has been spread, the area shall be thoroughly pulverized and the fertilizer incorporated in the top four (4) inches of the graded areas.
3. KIND AND QUANTITY OF FERTILIZER. fertilizer and agriculture limestone shall be applied at the following rates:

Combination fertilizer - 13-13-13 - 800 lbs. per acre
Agricultural limestone - 2 tons per acre

4. SEEDING AND/OR SODDING. Seeding and/or sodding is required on disturbed areas specified in the permit or by a representative of the Department. All areas should receive the seeding as follows:

Permanent Grassing Schedule
Common Bermuda - 15 lbs. per acre - year round
Bahia - 30 lbs. per acre - year round
Fescue (Ky.31) - 20 lbs. per acre - August 1 - April 1
Crimson Clover - 15 lbs. per acre -August 1 - April 1

Temporary Grassing Schedule
Rye Grass - 25 lbs. per acre - September 1 - March 31
Oats - 90 lbs. per acre - September 1 - December 15

No Crimson Clover or Bahia grass is to be planted in the Delta and no Bahia grass is to be planted in city sections

SHEET NO. _____ OF _____
PERMIT NO. _____

REVISIONS			
APPLICANT		MDOT	
DATE	BY	DATE	BY

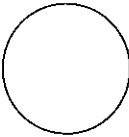

SHOW NORTH

5/29/2014 10:41:53 ECD-3 (1).dgn

FILED
MISSISSIPPI DEPARTMENT OF TRANSPORTATION

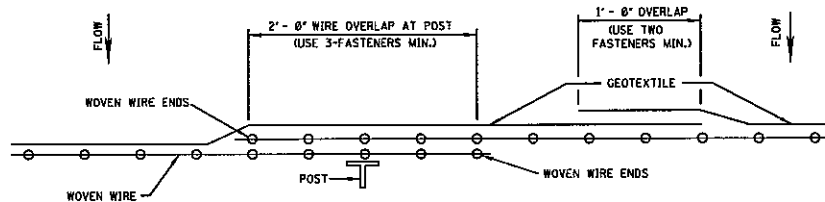

PLAN VIEW
REQUIRED LAPPING

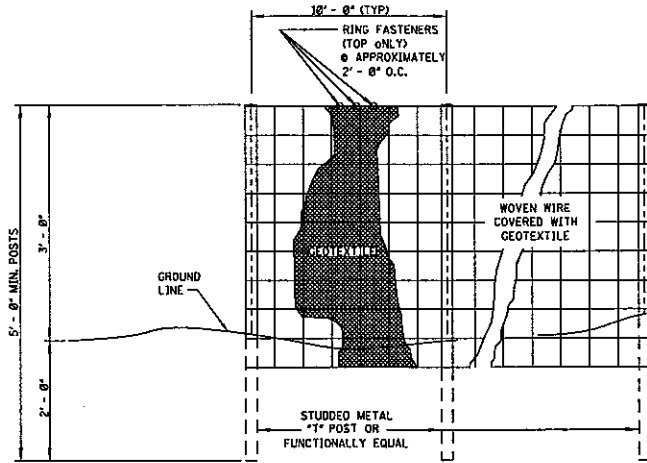

ELEVATION VIEW

- NOTES:
1. SILT FENCES SHALL BE USED IN AREAS WHERE FLOW IS NOT SEVERE.
 2. SILT FENCES ARE TEMPORARY SEDIMENT CONTROL ITEMS THAT SHALL BE ERECTED OPPOSITE ERODIBLE AREAS SUCH AS NEWLY GRADED FILL SLOPES AND ADJACENT TO STREAMS AND CHANNELS.
 3. SILT FENCE SHOULD BE PLACED WELL INSIDE RIGHT-OF-WAY AND ALONG EDGE OF CLEARING LIMITS. THIS WILL ALLOW ROOM FOR A BACK-UP FENCE IF FIRST FENCE BECOMES FULL.
 4. WHEREVER POSSIBLE SILT FENCE SHALL BE CONSTRUCTED ACROSS A LEVEL AREA IN THE SHAPE OF A SMILE. THIS AIDS IN PONDING OF RUNOFF AND FACILITATES SEDIMENTATION.
 5. THE CONTRACTOR MAY ELECT TO USE EITHER METHOD I OR METHOD II. COST TO BE LINEAR FEET OF SILT FENCE.
 6. METHOD II INSTALLATION SHALL BE ACCOMPLISHED USING AN IMPLEMENT THAT IS MANUFACTURED FOR THE APPLICATION AND PROVIDES A CONFIGURATION MEETING THE REQUIREMENTS OF THE DETAIL.
 7. WIRE SHALL BE MINIMUM OF 32\"/>
 8. GEOTEXTILE FABRIC MEETING THE TYPE II MATERIAL REQUIREMENTS AND INSTALLED ACCORDING TO SPECIFICATION MAY BE USED WITHOUT WIRE FENCE.

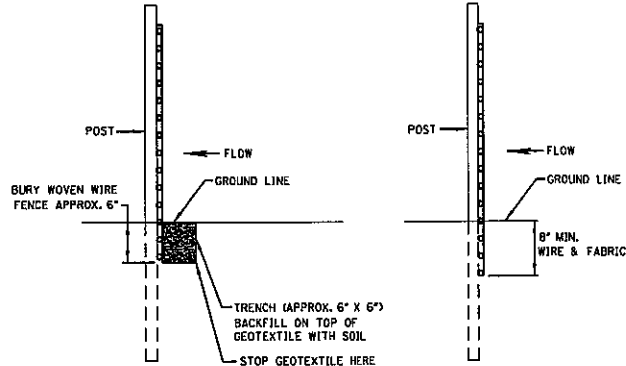

METHOD I

METHOD II
MECHANICAL INSTALLATION

SIDE VIEW

MISSISSIPPI DEPARTMENT OF TRANSPORTATION	
DETAILS OF SILT FENCE INSTALLATION	
DATE	DESIGN TEAM
BY	CREATED
REVISION	DATE
WORKING NUMBER ECD-3	
SHEET NUMBER	
FILENAME: EROSION_CONTROL\ECD-3.DGN	

SHEET NO. _____ **OF** _____
PERMIT NO. _____

REVISIONS			
APPLICANT		MDOT	
DATE	BY	DATE	BY

SHOW NORTH

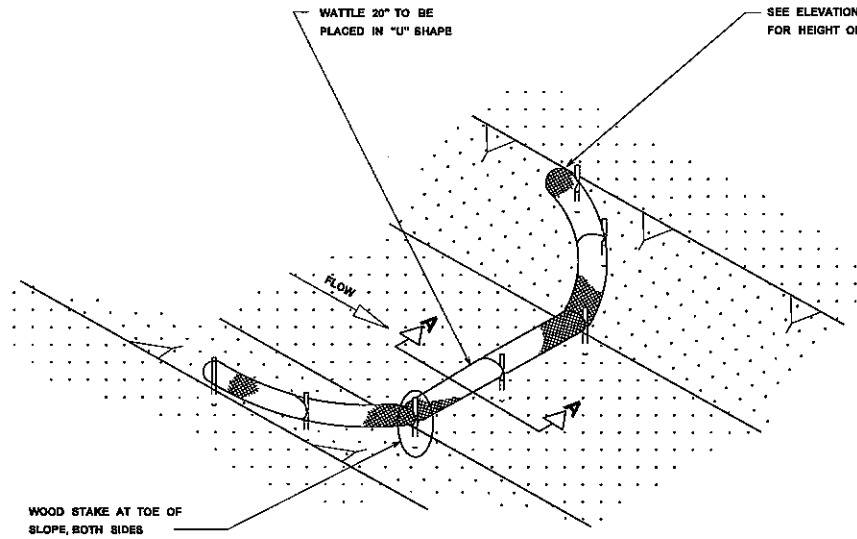

DETAIL (DITCH CHECK)

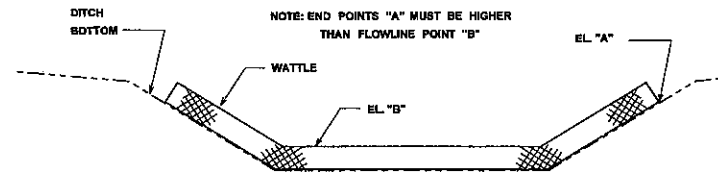

ELEVATION DETAIL

WATTLE DITCH CHECK SELECTION GUIDELINES

WATTLE DITCH CHECKS ARE APPROPRIATE FOR VELOCITY REDUCTION AND CONTROL OF SEDIMENT TRANSPORT UNDER LOW TO MEDIUM FLOW CONDITIONS.

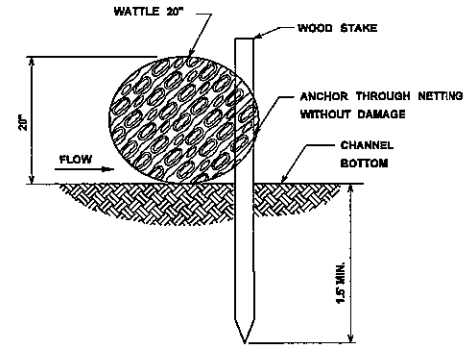

SECTION A-A

NOTES:

1. MINIMUM RECOMMENDED PLACEMENT INTERVAL BETWEEN WATTLE DITCH CHECK IS 100' UNLESS SHOWN OTHERWISE ON THE PLANS OR EROSION CONTROL PLAN APPROVED BY THE ENGINEER. SEE SPACING GUIDANCE ON ECD-4
2. ANCHORING WOOD STAKES SHALL BE SIZED, SPACED, DRIVEN, AND BE OF A MATERIAL THAT EFFECTIVELY SECURES THE CHECK. STAKE SPACING SHALL BE A MAXIMUM OF THREE FEET. ALL NON-DEGRADABLE MATERIALS SHALL BE REMOVED WHEN NO LONGER NEEDED.
3. TRENCHING OF WATTLES MAY BE NECESSARY IF PIPING BECOMES EVIDENT.
4. WATTLES SHOULD NOT BE USED IN HARD BOTTOM CHANNELS.

[illegible]